

CONSTRUCTION AND CIRCULATION UPDATE - SUMMER 26

ALL DATES, BOUNDARIES, ROUTES & DURATIONS SUBJECT TO CHANGE

MARCH 19, 2026

ROUTE 59 UPDATES AND MIDWAY DRIVE CLOSING

KENT STATE UNIVERSITY - OUA

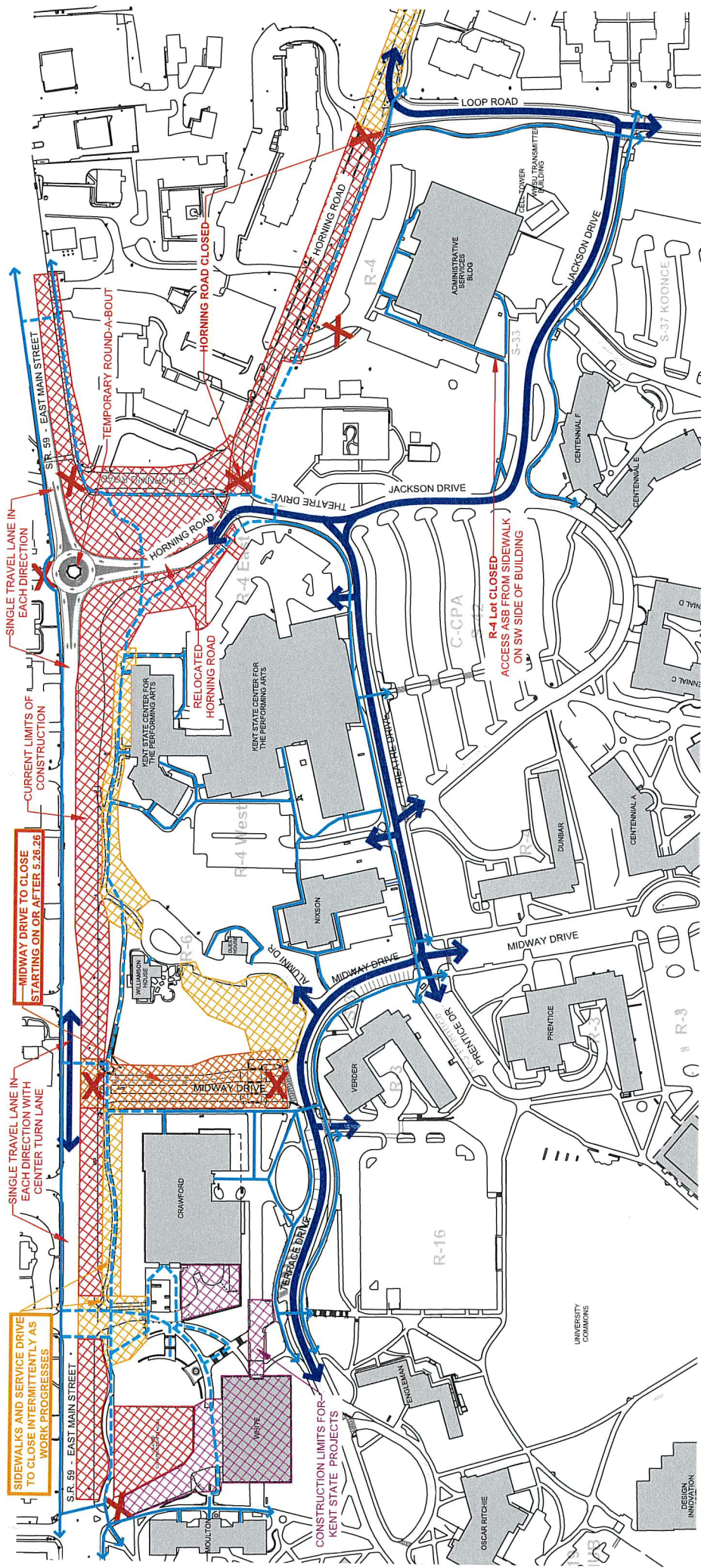

LEGEND:

LIMITS OF CONSTRUCTION

- Red hatched box: CURRENT LIMITS
- Orange hatched box: ADDITIONAL CONSTRUCTION LIMITS BEGINNING 5.26.26 - MIDWAY DRIVE CLOSED
- Yellow hatched box: UPCOMING - CONSTRUCTION LIMITS INTERMITTENTLY AS WORK PROGRESSES
- Purple hatched box: CONSTRUCTION LIMITS FOR SEPARATE PROJECTS

CIRCULATION

- Red 'X': ROAD CLOSED
- Blue arrow: VEHICLE ROUTE (BI-DIRECTIONAL)
- Light blue arrow: SIDEWALKS NOT EXPECTED TO BE DISRUPTED BY CONSTRUCTION
- Dashed blue arrow: SIDEWALKS CLOSED INTERMITTENTLY AS WORK PROGRESSES